

GENIE® GTH™ TELEHANDLER PARTS

FIND YOUR FIT



Genie®

QUALITY BY DESIGN

TABLE OF CONTENTS



Attachments and Forks	04
Augers	08
Tires and Wheels	12
Seats	14
Glass	16
Lights	18
Filter Kits	19
Safety and Other Accessories	20

CONTACT OUR PARTS DEPARTMENT

Phone: (877) 367-5606

Fax: (888) 274-6192

Email: AWP.PartsSalesPO@terex.com

Ecommerce: Parts.GenieLift.com

QUALITY FIT, EVERY TIME

Genie's commitment to quality in all we do means Genie® Genuine Parts deliver the dependability you and your customers count on to maximize uptime and productivity.

Anytime you need to replace a part, you can have confidence that Genie Genuine Parts were engineered specifically for your equipment, every time.



MADE TO LIFT

FORKS FOR GTH™ TELEHANDLERS



Highest
Quality Standards



Durable
Steel Construction



Engineered for
Genie® Machines

- Load, unload and transport materials with confidence and ease
- Save money by replacing less often
- Standard forks, lumber forks, and cubing tines available in multiple sizes to suit your jobsite demands





TYPE	CAPACITY/PAIR AT 24 IN LOAD CENTER	LENGTH	THICKNESS	WIDTH	PIN DIA	MODELS	PART NUMBER
ITA CL2	5,500 lb 2594 kg	48 in 121 cm	1.5 in 3.8 cm	4 in 10 cm	N/A	GTH™ -5519	09.0803.0071GT
Pallet	5,500 lb 2594 kg	48 in 121 cm	1.5 in 3.8 cm	4 in 10 cm	2.25 in 5.7 cm	GTH-5519	216560GT
Pallet	5,500 lb 2594 kg	60 in 152 cm	1.5 in 3.8 cm	4 in 10 cm	2.25 in 5.7 cm	GTH-5519	216561GT
Pallet	5,500 lb 2594 kg	48 in 121 cm	1.5 in 3.8 cm	4 in 10 cm	2.25 in 5.7 cm	GTH-5519	216562GT
Pallet	5,500 lb 2594 kg	60 in 152 cm	1.5 in 3.8 cm	4 in 10 cm	2.25 in 5.7 cm	GTH-5519	216563GT
Pallet	6,800 lb 3084 kg	48 in 121 cm	1.75 in 4.4 cm	4 in 10 cm	2.25 in 5.7 cm	GTH-5519	51.1301.9236GT
Pallet	8,400 lb 3810 kg	48 in 121 cm	2 in 5 cm	4 in 10 cm	2 in 5 cm	GTH-636, GTH-844	1255050GT
Pallet	8,400 lb 3810 kg	60 in 152 cm	2 in 5 cm	4 in 10 cm	2 in 5 cm	GTH-636, GTH-844	1255051GT
Pallet	8,400 lb 3810 kg	72 in 182 cm	2 in 5 cm	4 in 10 cm	2 in 5 cm	GTH-636, GTH-844	1255052GT
Lumber	12,200 lb 5443 kg	60 in 152 cm	1.75 in 4.4 cm	7 in 17.7 cm	2 in 5 cm	GTH-636, GTH-844	3-1467-60GT
Cubing	8,400 lb 3810 kg*	48 in 121 cm	2 in 5 cm	2 in 5 cm	2 in 5 cm	GTH-636, GTH-844	3-1085-10GT
Pallet	12,200 lb 5443 kg	48 in 121 cm	2.38 in 6 cm	4 in 10 cm	2.25 in 5.7 cm	GTH-1056, GTH-1256	1254548GT
Pallet	12,200 lb 5443 kg	60 in 152 cm	2.38 in 6 cm	4 in 10 cm	2.25 in 5.7 cm	GTH-1056, GTH-1256	1254549GT
Pallet	12,200 lb 5443 kg	72 in 182 cm	2.38 in 6 cm	4 in 10 cm	2.25 in 5.7 cm	GTH-1056, GTH-1256	1254550GT
Pallet	15,200 lb 6894 kg	60 in 152 cm	2.25 in 5.7 cm	5 in 12.7 cm	2.25 in 5.7 cm	GTH-1056, GTH-1256	1254552GT
Lumber	12,200 lb 5443 kg	60 in 152 cm	1.75 in 4.4 cm	7 in 17.7 cm	2.25 in 5.7 cm	GTH-1056, GTH-1256	1254553GT
Cubing	8,400 lb 3810 kg**	48 in 121 cm	2 in 5 cm	2 in 5 cm	2.25 in 5.7 cm	GTH-1056, GTH-1256	1254551GT

*Always refer to your machine's load chart and never exceed its rated capacity.

**4 cubing tines

JOB FLEXIBILITY

GTH™ TELEHANDLER ATTACHMENTS



CARRIAGES

Available in standard quick attach, side-shift or rotate styles, allowing precise and efficient load placement and maneuvering. The side-shift carriage moves 4 in left/right and the rotate carriage rotates 10° in both directions.



BUCKETS

Durable, reinforced buckets are available to suit your bulk material handling needs. Available in standard, heavy duty and grapple style.



TRUSS BOOMS

The perfect solution for overhead lifting, such as trusses or bulky materials.

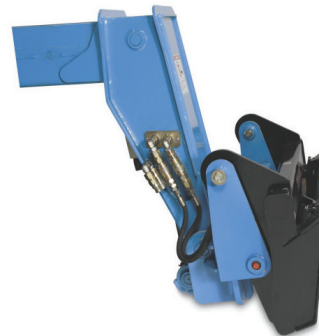

UNIVERSAL ADAPTERS

Increase the versatility of your fleet. The adapter allows you to attach a wide variety of skid steer-type attachments in seconds.

ADAPTERS AND BUCKETS

DESCRIPTION	PART NUMBER	COMPATIBLE PRODUCTS
Universal Skid Steer Adapter	117543-SGT	GTH™-5519
Industrial Grapple Bucket	117930-SGT	GTH-5519
Heavy Duty Multi-Purpose Bucket	117687-SGT	GTH-5519
Cutting Edge Kit	236372GT	GTH-5519
72 in 1.00 CU YD Heavy Duty Multi-Purpose Bucket	1322426GT	GTH-636, GTH-844, GTH-1056, GTH-1256
96 in 1.50 CU YD Heavy Duty Multi-Purpose Bucket	1322427GT	GTH-636, GTH-844, GTH-1056, GTH-1256

TRUSS BOOM

TYPE	MAX REACH	PART NUMBER	COMPATIBLE PRODUCTS
Fixed Reach	6 ft 1.8 m	117580-SGT	GTH-5519
Variable Reach	8 ft 2.4 m	1254389-SGT	GTH-1056
Variable Reach	13 ft 4 m	1322425GT	GTH-636, GTH-844, GTH-1056, GTH-1256

CARRIAGES

DESCRIPTION	SIZE	PART NUMBER	COMPATIBLE PRODUCTS
Standard Carriage	48 in 122 cm	216559GT*	GTH-5519
Standard Carriage	48 in 122 cm	226814GT	GTH-636, GTH-844
Standard Carriage	48 in 122 cm	1254390GT	GTH-1056
Standard Carriage	48 in 122 cm	1316563GT	GTH-1256
Standard Carriage	60 in 152 cm	226813GT	GTH-636, GTH-844
Standard Carriage	60 in 152 cm	1254391GT	GTH-1056
Standard Carriage	60 in 152 cm	1316569GT	GTH-1256
Standard Carriage	72 in 183 cm	226812GT	GTH-636, GTH-844
Standard Carriage	72 in 183 cm	1254392GT	GTH-1056
Standard Carriage	72 in 183 cm	1316573GT	GTH-1256
Rotate Carriage	48 in 122 cm	117884-SGT	GTH-5519
Rotate Carriage	48 in 122 cm	822265GT	GTH-636, GTH-844
Rotate Carriage	48 in 122 cm	1254383GT	GTH-1056, GTH-1256
Rotate Carriage	60 in 152 cm	216572GT	GTH-1256, GTH-1544
Rotate Carriage	60 in 152 cm	1255635GT	GTH-636, GTH-844
Rotate Carriage	60 in 152 cm	1254384GT	GTH-1056, GTH-1256
Rotate Carriage	72 in 183 cm	1254385GT	GTH-1056, GTH-1256
Rotate Carriage	72 in 183 cm	55.0750.0129GT	GTH-1256, GTH-1544
Swing Carriage	72 in 183 cm	1259576GT	GTH-636, GTH-844
Swing Carriage	72 in 183 cm	1254386GT	GTH-1056, GTH-1256
Side-Shift Carriage	N/A	117883-SGT	GTH-5519
Side-Shift Carriage	48 in 122 cm	1322421GT	GTH-636, GTH-844
Side-Shift Carriage	48 in 122 cm	1322423GT	GTH-1056, GTH-1256
Fork Positioner Carriage	48 in 122 cm	1322422GT	GTH-636, GTH-844
Fork Positioner Carriage	48 in 122 cm	1322424GT	GTH-1056, GTH-1256

*Carriage only, order pin/hardware separately

GROUNDBREAKING ATTACHMENTS

AUGER DRIVE MOTORS FOR THE GTH™-5519 TELEHANDLER

BENEFITS

- Tear through the ground effortlessly with high-pressure capabilities, making drilling a swift and efficient process
- Designed for the GTH-5519, the auger drive motor is also compatible with high- and standard-flow skid steers, offering adaptability across different equipment
- Reducing the need for frequent replacements and/or maintenance, the auger drive motors are designed for durability and longevity



GENIE PART NUMBER	GENIE DESCRIPTION
1327906GT	GENIE 5K-GEARBOX ASSEMBLY-2.5 in HEX
1327907GT	GENIE 3K-GEARBOX ASSEMBLY-2.5 in HEX
1327908GT	GENIE 5K-GEARBOX ASSEMBLY-2.5 in HEX-HALO
1327909GT	GENIE 3K-GEARBOX ASSEMBLY-2.5 in HEX-HALO
1327910GT	FRAME ASSY, MULTIFIT-HEAVY DUTY CENTER MOUNT FRAME
1327911GT	FRAM ASSY, GTH-5519 HEAVY DUTY CENTER MOUNT FRAME
1327912GT	HALO BATTERY KIT
1327992GT	AUGER ADAPTER - 2.5 in HEX FEMALE 2 in HEX MALE

GENIE PART NUMBER	GENIE DESCRIPTION
1327913GT	AUGER, 8 in DIA, 2.5 in DRIVE, FLAT TOOTH, GENERAL
1327914GT	AUGER, 9 in DIA, 2.5 in DRIVE, FLAT TOOTH, GENERAL
1327915GT	AUGER, 10 in DIA, 2.5 in DRIVE, FLAT TOOTH, GENERAL
1327916GT	AUGER, 12 in DIA, 2.5 in DRIVE, FLAT TOOTH, GENERAL
1327917GT	AUGER, 14 in DIA, 2.5 in DRIVE, FLAT TOOTH, GENERAL
1327918GT	AUGER, 16 in DIA, 2w.5 in DRIVE, FLAT TOOTH, GENERAL
1327919GT	AUGER, 18 in DIA, 2.5 in DRIVE, FLAT TOOTH, GENERAL
1327920GT	AUGER, 20 in DIA, 2.5 in DRIVE, FLAT TOOTH, GENERAL
1327921GT	AUGER, 24 in DIA, 2.5 in DRIVE, FLAT TOOTH, GENERAL
1327922GT	AUGER, 30 in DIA, 2.5 in DRIVE, FLAT TOOTH, GENERAL
1327923GT	AUGER, 36 in DIA, 2.5 in DRIVE, FLAT TOOTH, GENERAL
1327924GT	AUGER, 40 in DIA, 2.5 in DRIVE, FLAT TOOTH, GENERAL
1327925GT	AUGER, 48 in DIA, 2.5 in DRIVE, FLAT TOOTH, GENERAL
1327926GT	AUGER, 8 in DIA, 2.5 in DRIVE, FLAT TOOTH, SOFT ROCK
1327927GT	AUGER, 9 in DIA, 2.5 in DRIVE, FLAT TOOTH, SOFT ROCK
1327928GT	AUGER, 10 in DIA, 2.5 in DRIVE, FLAT TOOTH, SOFT ROCK
1327929GT	AUGER, 11 in DIA, 2.5 in DRIVE, FLAT TOOTH, SOFT ROCK
1327930GT	AUGER, 14 in DIA, 2.5 in DRIVE, FLAT TOOTH, SOFT ROCK
1327931GT	AUGER, 16 in DIA, 2.5 in DRIVE, FLAT TOOTH, SOFT ROCK
1327932GT	AUGER, 18 in DIA, 2.5 in DRIVE, FLAT TOOTH, SOFT ROCK
1327933GT	AUGER, 20 in DIA, 2.5 in DRIVE, FLAT TOOTH, SOFT ROCK
1327934GT	AUGER, 24 in DIA, 2.5 in DRIVE, FLAT TOOTH, SOFT ROCK
1327935GT	AUGER, 30 in DIA, 2.5 in DRIVE, FLAT TOOTH, SOFT ROCK
1327936GT	AUGER, 36 in DIA, 2.5 in DRIVE, FLAT TOOTH, SOFT ROCK
1327937GT	AUGER, 40 in DIA, 2.5 in DRIVE, FLAT TOOTH, SOFT ROCK
1327938GT	AUGER, 48 in DIA, 2.5 in DRIVE, FLAT TOOTH, SOFT ROCK
1327939GT	AUGER, 6 in DIA, 2.5 in DRIVE, TAPERED TOOTH, ALL PURPOSE
1327940GT	AUGER, 8 in DIA, 2.5 in DRIVE, TAPERED TOOTH, ALL PURPOSE
1327941GT	AUGER, 9 in DIA, 2.5 in DRIVE, TAPERED TOOTH, ALL PURPOSE
1327942GT	AUGER, 10 in DIA, 2.5 in DRIVE, TAPERED TOOTH, ALL PURPOSE
1327943GT	AUGER, 12 in DIA, 2.5 in DRIVE, TAPERED TOOTH, ALL PURPOSE
1327944GT	AUGER, 14 in DIA, 2.5 in DRIVE, TAPERED TOOTH, ALL PURPOSE
1327945GT	AUGER, 16 in DIA, 2.5 in DRIVE, TAPERED TOOTH, ALL PURPOSE
1327946GT	AUGER, 18 in DIA, 2.5 in DRIVE, TAPERED TOOTH, ALL PURPOSE
1327947GT	AUGER, 20 in DIA, 2.5 in DRIVE, TAPERED TOOTH, ALL PURPOSE

GENIE PART NUMBER	GENIE DESCRIPTION
1327948GT	AUGER, 24 in DIA, 2.5 in DRIVE, TAPERED TOOTH, ALL PURPOSE
1327949GT	AUGER, 30 in DIA, 2.5 in DRIVE, TAPERED TOOTH, ALL PURPOSE
1327950GT	AUGER, 36 in DIA, 2.5 in DRIVE, TAPERED TOOTH, ALL PURPOSE
1327951GT	AUGER, 40 in DIA, 2.5 in DRIVE, TAPERED TOOTH, ALL PURPOSE
1327952GT	AUGER, 48 in DIA, 2.5 in DRIVE, TAPERED TOOTH, ALL PURPOSE
1327953GT	AUGER, 6 in DIA, 2.5 in DRIVE, HEAVY DUTY
1327954GT	AUGER, 9 in DIA, 2.5 in DRIVE, HEAVY DUTY
1327955GT	AUGER, 12 in DIA, 2.5 in DRIVE, HEAVY DUTY
1327956GT	AUGER, 14 in DIA, 2.5 in DRIVE, HEAVY DUTY
1327957GT	AUGER, 16 in DIA, 2.5 in DRIVE, HEAVY DUTY
1327958GT	AUGER, 18 in DIA, 2.5 in DRIVE, HEAVY DUTY
1327959GT	AUGER, 24 in DIA, 2.5 in DRIVE, HEAVY DUTY
1327960GT	AUGER, 30 in DIA, 2.5 in DRIVE, HEAVY DUTY
1327961GT	AUGER, 36 in DIA, 2.5 in DRIVE, HEAVY DUTY
1327962GT	AUGER EXTENSION, 4 FT, OUTER, 2.5 in DRIVE
1327963GT	AUGER EXTENSION, 5 FT, OUTER, 2.5 in DRIVE
1327964GT	AUGER EXTENSION, 6 FT, OUTER, 2.5 in DRIVE
1327965GT	AUGER EXTENSION, 8 FT, OUTER, 2.5 in DRIVE
1327966GT	AUGER EXTENSION, 10 FT, OUTER, 2.5 in DRIVE
1327967GT	AUGER EXTENSION, 4 FT, INNER, 2.5 in DRIVE
1327968GT	AUGER EXTENSION, 6 FT, INNER, 2.5 in DRIVE
1327969GT	AUGER EXTENSION, 8 FT, INNER, 2.5 in DRIVE
1327970GT	PIN LINKAGE KIT
1327971GT	PIN, HOOD/BAIL
1327972GT	LYNCH PIN, BLACK
1327973GT	PIN, 2.5 in DRIVE
1327974GT	DRIVE FRAME, SKID STEER, MULTIFIT
1327975GT	DRIVE FRAME, GTH-5519
1327976GT	OUTPUT SHAFT SEAL
1327977GT	O-RING, GEARBOX

GENIE PART NUMBER	GENIE DESCRIPTION
1327978GT	SEAL KIT, 6K FRONT MOTOR
1327979GT	SEAL KIT, 6K REAR MOTOR
1327980GT	PILOT KIT, MEDIUM, HEX DRIVE, GENERAL
1327981GT	TOOTH, MEDIUM, GENERAL
1327982GT	TOOTH, MEDIUM CHISEL, GENERAL
1327983GT	TOOTH, MEDIUM, SOFT ROCK
1327984GT	TOOTH, MEDIUM CHISEL, SOFT ROCK
1327985GT	PILOT KIT, HEAVY DUTY
1327986GT	TOOTH, TAPER POINT, OUTER
1327987GT	TOOTH, TAPER POINT, INNER
1327988GT	TOOTH, AUGER BODY, SHORT, CAPPED, HEAVY DUTY
1327989GT	TOOTH, AUGER BODY, LONG, INSTERTED, HEAVY DUTY
1327990GT	PILOT, 19PK, 2 3/8 in API THREAD
1327991GT	KIT, PILOT, 19PK TANG DRIVE
1327993GT	OPERATOR'S MANUAL, GENIE AUGER

DURABLE AND MADE TO LAST



TIRES FOR TELEHANDLERS

- Resistant to abrasions, cuts and chips
- Secure and comfortable ride
- Durable tire for fewer replacements

AVAILABLE TREAD PATTERNS

- Rough terrain: For performance and traction on muddy and wet ground
- Non-marking: Prevents black tire marks on concrete
- Turf: For sensitive surfaces



ENDURO A/T™ TIRES

- Longer life: Up to 30% longer life than comparable OEM tires
- Center tread: Ensures smooth ride and is wear-resistant on rocky terrain
- Outside tread: Increased surface area and wide spacing for traction in mud and dirt

TIRES FOR TELEHANDLERS

MODELS	TYPE	FOAM FILLED ASSEMBLIES		AIR FILLED ASSEMBLIES		TIRE ONLY
		RIGHT	LEFT	RIGHT	LEFT	
GTH™-5519	Standard Black	55.0403.0095GT	55.0403.0088GT	55.0403.0089GT	55.0403.0090GT	09.4627.0018GT
	Non-Marking	55.0403.0093GT	55.0403.0094GT	N/A	N/A	09.4627.0034GT
	Solid	55.0403.0082GT	55.0403.0081GT	N/A	N/A	N/A
	Turf	N/A	N/A	1298023GT		1298024GT
	Enduro A/T™	1303230GT		1303228GT		1303244GT
GTH-636	Standard Black	1303213GT	1303214GT	1303210GT	1303211GT	1303243GT
	Enduro A/T	1303234GT		1303232GT		1303244GT
GTH-844	Standard Black	1303225GT	1303226GT	1303222GT	1303223GT	1303243GT
	Enduro A/T	1303238GT		1303236GT		1303241GT
GTH-1056	Standard Black	1303219GT	1303220GT	1303217GT	1303216GT	1303240GT
	Enduro A/T	1303238GT		1303236GT		1303241GT
GTH-1256	Enduro A/T	1311584GT		1310950GT		1310948GT

ENDURO A/T TIRES

PART NUMBER	DESCRIPTION	MODEL	TIRE DETAIL
1303228GT	TIRE & WHEEL, 13x28 AIR, ENDURO	GTH-636	Air
1303230GT	TIRE & WHEEL, 13x28 CRUMB, ENDURO	GTH-636	Foam
1303244GT	TIRE, ENDURO, 13x28,12PR	GTH-636	Tire Only
1303232GT	TIRE & WHEEL, 13x28 AIR, 10-BOLT ENDURO	GTH-844	Air
1303234GT	TIRE & WHEEL, 13x28 FOAM, 10-BOLT ENDURO	GTH-844	Foam
1303244GT	TIRE, ENDURO, 13x28,12PR	GTH-844	Tire Only
1303236GT	TIRE & WHEEL, 14x28 AIR, ENDURO	GTH-1056	Air
1303238GT	TIRE & WHEEL, 14x28 CRUMB, ENDURO	GTH-1056	Foam
1303241GT	TIRE, ENDURO, 14x28,12PR	GTH-1056	Tire Only
1310950GT	TIRE & WHEEL, 14x28 AIR, ENDURO, 16PR	GTH-1256	Air
1311584GT	TIRE & WHEEL, 14x28 CRUMB, ENDURO, 16PR	GTH-1256	Foam
1310948GT	TIRE, ENDURO, 14x28,16PR	GTH-1256	Tire Only



QUALITY COMFORT

GENIE® GTH™ SEATS

Genie GTH seats are designed to provide enhanced operator comfort. Both seat assembly kits and individual seat components are available.

FEATURES

- Multiple adjustment points
- Built-in arm rest
- Suspension seat

BENEFITS

- Ergonomic positioning
- Durable construction



	GTH™-5519	GTH-636, GTH-844	GTH-1056, GTH-1256
SEAT ASSEMBLY	09.4610.0056GT	1276678GT	1296180GT
SEAT BOTTOM	07.0703.0509GT	1253474GT	1296541GT
	N/A	N/A	N/A
SEAT BACK	07.0703.0508GT	1253475GT	1296542GT
	N/A	N/A	N/A
SEAT BELT	09.4610.0043GT	1277224GT	1296540GT
	N/A	1289660GT	1289660GT
ARM REST	N/A	229304GT (pad)	1296539GT
	N/A	1263776GT (arm rest)	N/A
KNOB	07.0723.0717GT	1263770GT	N/A
TRACK	N/A	1263771GT	1296538GT
CABLE TETHER KIT	N/A	1263774GT	1296568GT

OTHER COMPONENTS		
DESCRIPTION	PART NUMBER	MODELS
Shock absorber, seat	09.4610.0025GT	GTH-5519
Seat adjustment handle	1260062GT	GTH-636, GTH-844

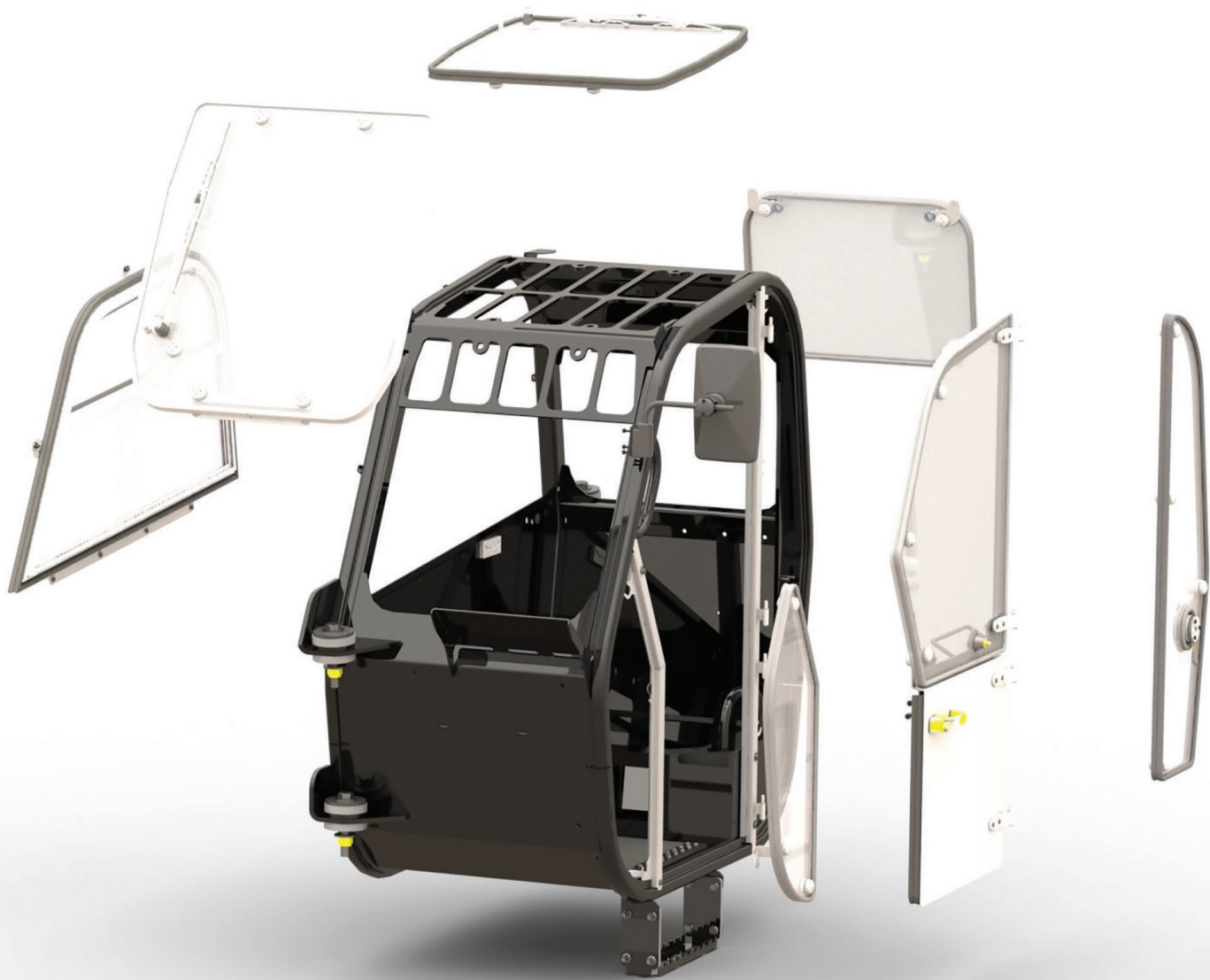

CLEARVIEW FOCUS

GLASS

- High-quality range of glazing, specifically designed for Genie® cabs
- Assemblies come with the weather stripping pre-installed, all required hardware, and the windshield wiper assembly (where applicable)

	GTH™-5519		GTH-636, GTH-844, GTH-1056, GTH-1256	
	ASSEMBLIES	GLASS ONLY	ASSEMBLIES	GLASS ONLY
WINDSHIELD (FRONT) GLASS	N/A	07.0723.0649GT	230043GT	230044GT
RIGHT SIDE GLASS	N/A	07.0723.0165GT	231330GT	230045GT
RIGHT REAR WINDOW	N/A	N/A	236782GT	236783GT
ROOF (SKYLIGHT) GLASS	N/A	07.0723.0168GT	230008GT	230007GT
REAR GLASS	N/A	07.0723.0760GT	130164GT	130161GT
UPPER DOOR FRAME	07.0723.0684GT	07.0723.0426GT	231118GT	231119GT
LEFT SIDE GLASS	N/A	07.0723.0764GT	130243GT	130132GT
REAR LOWER GLASS	N/A	N/A	N/A	N/A



LIGHT UP THE WAY

WORK AND ROAD LIGHT KITS

- Improve visibility for night and low-light operations
- Increase worker productivity
- Save time and money with integrated lights

KIT	PART NUMBER	MODEL	SERIAL NUMBER
WORK LIGHTS	58.2513.9048GT	GTH™-5519	All
ROAD LIGHTS	58.1701.4027GT	GTH-5519	All



MAINTENANCE MADE EASY

GENIE® GENUINE ENGINE FILTER KITS

- Convenient, single part number kit for all your needs
- 500-hour service filters
- Secure packaging for easy transport
- Save money with routine engine maintenance



PART NUMBER	ENGINE	AVAILABLE ON
1278719GT	Deutz TD 2.9L4 T4F	GTH™-5519
1278721GT	Deutz TD 2.9L4 T4F	GTH-844
1307312GT	Deutz TCD 3.6L T4F 121 HP	GTH-1056
1307311GT	Deutz TD 2.9L4 T4F	GTH-636

OTHER ACCESSORIES



FIRE EXTINGUISHER

An extra feature available for your Genie® GTH™ telehandler.

PART NUMBER	AVAILABLE ON
123563GT	GTH-5519, GTH-636, GTH-844, GTH-1056 and GTH-1256



FLASHING BEACON

When mounted to the top of the telehandler's cab, these orange flashing lights warn workers when the telehandler is in motion.

PART NUMBER	AVAILABLE ON
58.1701.4047GT	GTH-5519, GTH-636, GTH-844, GTH-1056 and GTH-1256



REAR PROXIMITY ALARM

Sensors identify potential obstacles within a close radius of the back of the machine, and alert the operator via visual and auditory warnings.

PART NUMBER	AVAILABLE ON
1257987GT - Sensor	GTH-5519, GTH-686, GTH-844, GTH-1056 and GTH-1256
1257988GT - Display	
1275497GT - Kit	



OIL PAN HEATER

For use in cold weather conditions, the oil pan heater aids in machine start-up by keeping the engine oil warmed while the machine is not in use.

PART NUMBER	AVAILABLE ON
123518GT - Deutz/Perkins	GTH-5519
128274GT - Deutz, 120V, 150W	

NOTES

Worldwide Manufacturing And Distribution

Australia · Brazil · Caribbean · Central America · China · France · Germany · Italy · Japan · Korea · Mexico
Southeast Asia · Spain · Sweden · United Arab Emirates · United Kingdom · United States

Toll Free in USA/Canada **+1 (800) 536-1800** · Telephone **+1 (425) 881-1800** · Fax +1 (425) 883-3475

20021 120th Ave NE, Bothell, WA 98011

Effective Date: February 2024. Product specifications and prices are subject to change without notice of obligation. The video, audio, photographs and/or drawings in this document are for illustrative purposes only. Refer to the appropriate Operator's Manual for instructions on the proper use of this equipment. Failure to follow the appropriate Operator's Manual when using our equipment or to otherwise act irresponsibly may result in serious injury or death. The only warranty applicable to our equipment is the standard written warranty applicable to the particular product and sale and we make no other warranty, express or implied. Products and services listed may be trademarks, service marks or trade names of Terex Corporation and/or their subsidiaries in the USA and many other countries. Genie is a registered trademark of Terex South Dakota, Inc. 2024 Terex Corporation.
© 2024 Terex Corporation Terex. Genie is a trademark of Terex Corporation or its subsidiaries.

The Genie logo features the word "Genie" in a bold, white, sans-serif font. A small upward-pointing arrow is positioned above the letter 'i'. A registered trademark symbol (®) is located at the bottom right of the word.The "QUALITY BY DESIGN" logo consists of the words "QUALITY BY DESIGN" in a white, bold, sans-serif font. The word "BY" is smaller and positioned between "QUALITY" and "DESIGN". A small upward-pointing arrow is placed above the letter 'D' in "DESIGN".